



NOTE: THE ADJUSTMENTS IN STEPS 1 TO 3 ARE ONE-OFFS & WILL TAKE ABOUT 10 MINS BUT WILL NOT NEED TO BE REPEATED UNLESS YOU CHANGE YOUR CAR. ONLY USE X RACK ON A CLEAN ROOF!

PREPARATION FOR USE

Refer to the Pack Contents picture applicable to the model you have purchased shown on page 2, this will help you identify components.

800 model only

RUNNERS

Snap X Rack runners straight as shown right and fit into the slots on the X Rack body depending on the length of your load, 1 and 4 for long loads, 2 and 3 for short loads or any combination that supports your load best.

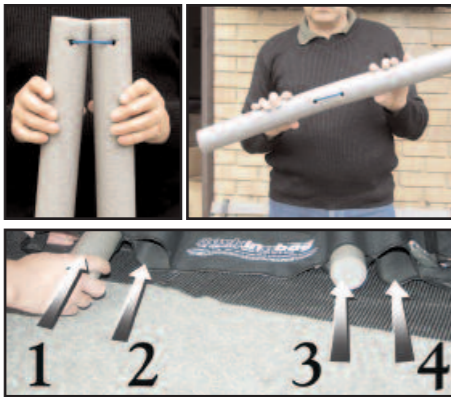

APPLIES TO ALL MODELS

STEP 1 - FIX HINGE BANDS TO FRONT DOOR HINGES

Open the front doors and feed the hinge band's smallest loop down behind and around the top hinge -Diag 3. Feed the larger loop through the small loop and pull tight creating an extended larger loop Diag 4. Repeat on the other side. DO NOT REMOVE THESE BANDS ONCE FITTED UNLESS YOU CHANGE YOUR CAR.

IMPORTANT NOTE: regular inspection should be made to ensure your door hinges do not damage these Bands in any way. If damage occurs do not use the rack - please call 01604 768598 and ask our helpline for advice.



STEP 2 - FIX MULTI-LOOP FIXING STRAPS TO HINGE BANDS ON THE FRONT DOORS

Take one of the Multi-Loop straps (shown in Fig X in Step 3) and feed the single loop end (b) through the Hinge Band's extended loop (Diag 4 and 5). Take the other end of the Multi-loop strap, end (a) and feed it through the loop of end (b) (Diag 6), pull end (a) tightly through creating a secure lasso locked around the Hinge Band. Repeat on other side door hinge. Your two front Multi-Loop straps should now be fully secured to the Hinge Bands and form the front fixing straps which we will now use to secure the leading edge of your X Rack in Step 3.

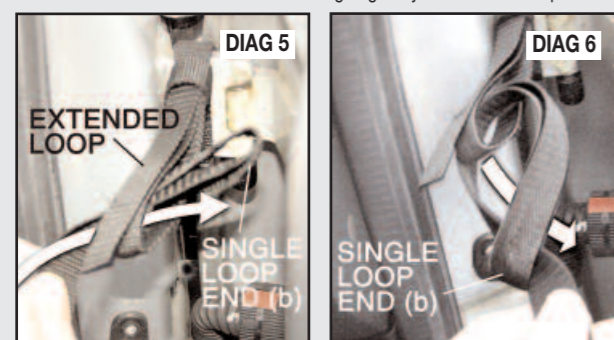

STEP 3 - ADJUSTING & FITTING REAR MULTI-LOOP FIXING STRAPS & TOURING CLIPS

Multi-loop Fixing Straps.

X Rack has four Multi-loop fixing straps, single loop end (b) and multi-loop end (a).

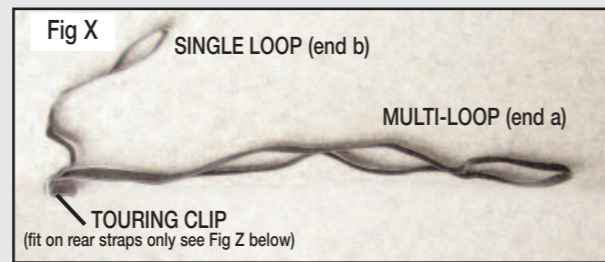

1. To adjust Multi-loop straps and fit Touring Clips for your car.

With the X Rack body placed centrally on your roof take the two front Multi-loop straps (as fitted in Step 2) to the leading edge of the X Rack body and secure the ends (a), through the front steel rings on your X Rack (as Diags 7 and 8) pull through until straps are taught but not tightened, do not move the X Rack from its central position.



Take the two remaining Multi-Loop straps and secure ends (a) to the rear steel rings of X Rack's body in an identical manner as the front straps (as Diags 7 and 8). Adjust the amount all straps fed through the steel rings to equal lengths (see Fig Y). Take ends (b), one at a time to the extreme rear corners and fold each up and back on itself 13 cm or 5" approx, beyond the shut line (see picture below). Feed the folded strap end through a Touring Clip (as Fig Z) locking the folded end over the Touring Clip's Retaining Foot. Repeat other side. Check straps are properly secured to Touring Clips and that straps cannot be pulled through the clips before use.

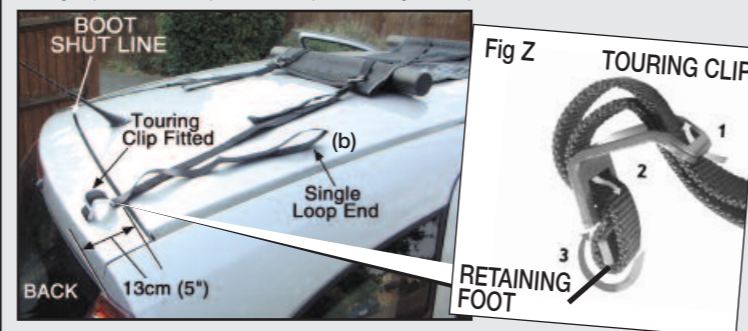

LONG LOADS

The remaining single loop of the straps (ends b) can be used to secure long items if fed back out onto the car roof (see LONG LOADS page 2), or can be left inside the boot unused. The strap adjustment is now complete for your vehicle. Remove X RACK from your vehicle by unclipping the Touring Clips from the boot seal to release tension in the front straps. Now only disconnect the front straps from the front of X Rack and from the Hinge Bands, DO NOT REMOVE the Hinge Bands themselves from the door hinges or the Rear Straps and Touring Clips from the back of the X Rack body as these are now adjusted perfectly for your vehicle for everyday use.

NOTE: TOURING CLIPS MUST NOT BE USED ON GLASS ONLY REAR HATCH DOORS OR IF THERE IS LESS THAN 20MM SPACE BETWEEN GLAZING AND RUBBER BOOT SEALS AS TOURING CLIPS COULD DAMAGE YOUR REAR WINDOW!

Touring Clip Foam Lugs are provided as an alternative fit and should be fitted as shown right with the Touring Clip reversed and the multi-loop fixing straps fed through the foam LUGs. Place these lugs in your boot in the same positions on the anti-slip pad as the Touring clips would be (see right).

Note when using Lugs you will not be able to access your boot or hatch during your journey as this will release your X Rack.

IMPORTANT: On Glass Only hatch doors, Glazed roofs or cars with Sunroofs we recommend Maximum loads should not exceed 25kg

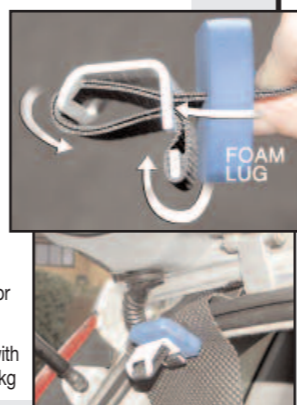

EVERYDAY USE

1. Place X Rack centrally on your vehicle roof with rear straps and Touring Clips to the rear (already fitted to your X Rack earlier). Open your boot or hatch and fit the rear straps as instructed below to their respective corners as far to each side as possible (see right and below).

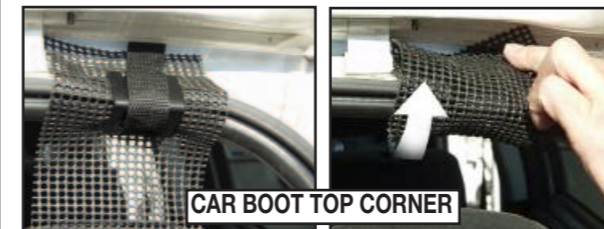
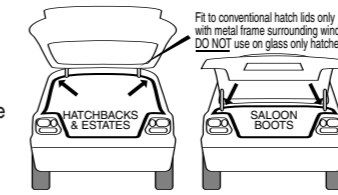

2. Place the anti-slip pads over the cars rubber seal at the far top corner bring the rear straps fitted to the X Rack as you did earlier in Step 3 and clip the Touring Clips over the anti-slip pad and rubber seals.

3. Wrap remaining anti-slip mat over the assembly to protect paintwork.

Always close lid slowly, do not force shut (see Warnings).

If your boot will not shut and Touring Clips are not suitable for your car you may have to fit Touring Clip Foam Lugs (see Step 3 NOTE)

NOTE: On some hatchback and estates, due to lack of space between the hatch lid and car body you may not be able to feed the Touring Clips from the X Rack through to the boot. In this case remove the rear straps from the X Rack body fit the Touring Clips first, feeding the straps to the X Rack and refitting as Diags 7 and 8. Any problems call our helpline on 01604 768598

4. Secure front straps by lassoing Multi-loop straps single ends to front door hinge loops as shown in Diag 5 and 6 and take the multi-loop ends and fix them to the front of your X Rack feeding them through their respective steel



rings as Diag 7 then through the lower ring as Diag 8 and tighten up all straps progressively until tight by pulling straps ends out away from the X Rack body as Diag 9.

Using strong Tie-Downs (not supplied as standard), fix your load by feeding a tie-down through all four multi-



loops G,H,J,K, over your load using the loops nearest the steel rings to secure your load initially but in the interest of safety all loose end loops must be secured together over your load. And tighten the tie-down well Diag 10. Additional straps and bungies may be needed to secure your load (see Fixing Points, photo top right) Before you start your journey we advise a thorough initial check and regular checks to see that your load is secure throughout your journey.

REMOVAL

To remove X Rack remove load and dislodge rear straps from boot. This will enable easy removal of front straps from the steel rings. At the door hinges disconnect the front straps from the Hinge Bands. DO NOT REMOVE REAR STRAPS FROM X RACK BODY as these straps will be ideally adjusted ready for future use. Roll up your X Rack and store in its bag in your car boot.

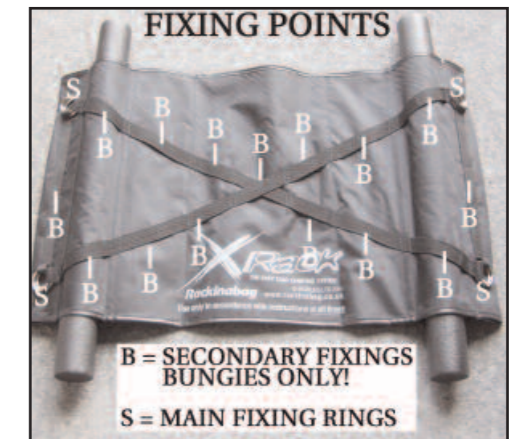

Gaps between the strap assembly are provided for bungee fixing only.

Non-elastic straps should be either connected to the steel rings or multi-loop straps on main fixing straps.

Helpline 01604 768598

MAX WEIGHT LIMIT 40kg.

IMPORTANT NOTE: THIS WEIGHT LIMIT IS SUBJECT TO THE STRENGTH OF YOUR CAR ROOF.



For useful hints on page 2.

WARNINGS

IMPORTANT ON SOME SALOONS:

If your saloons rear windscreen is close to the rear rubber seals in the boot, make sure that the touring Clips are well away from the rear windscreen and don't in any way allow clips to foul it or ride over it. For this reason closing the boot should be done **very slowly** and **with caution** to avoid any damage to the glazing or interior if fitted incorrectly. If so open and re-fit correctly. Do not attempt to force shut! Alternatively fit foam lugs as shown in Step 3 NOTE. If you need help please call our Helpline 01606 768598

ONLY USE X RACK IN ACCORDANCE WITH INSTRUCTIONS AT ALL TIMES. X RACK IS A 'SOFT RACK' AND IS NOT INTENDED TO CARRY LOADS THAT METAL ROOF RACKS ARE CAPABLE OF. PLEASE DO NOT EXCEED OUR RECOMMENDATIONS. BIGBOBS LTD IS NOT LIABLE FOR YOUR OVERLOADING OR CARELESS USE OF THIS PRODUCT. REMEMBER IT IS AN OFFENCE TO DRIVE WITH AN IMPROPERLY SECURED LOAD AND COULD ENDANGER PEDESTRIANS AND OTHER ROAD USERS!

In the interest of product development, Bigbobs Ltd reserves the right to alter specifications or colours without notice. All dimensions are approximate.

Usefull Tips

These usefull tips should help you get the most out of your X Rack. You might also find regularly visiting our website at:

www.xrack.co.uk

...very helpful as there is a fitting MOVIE and a Forum page for you and other users to add your tips and experiences with X Rack.

You can also download the most recent copy of these instruction which are updated from time to time as teh X Rack range evolves.

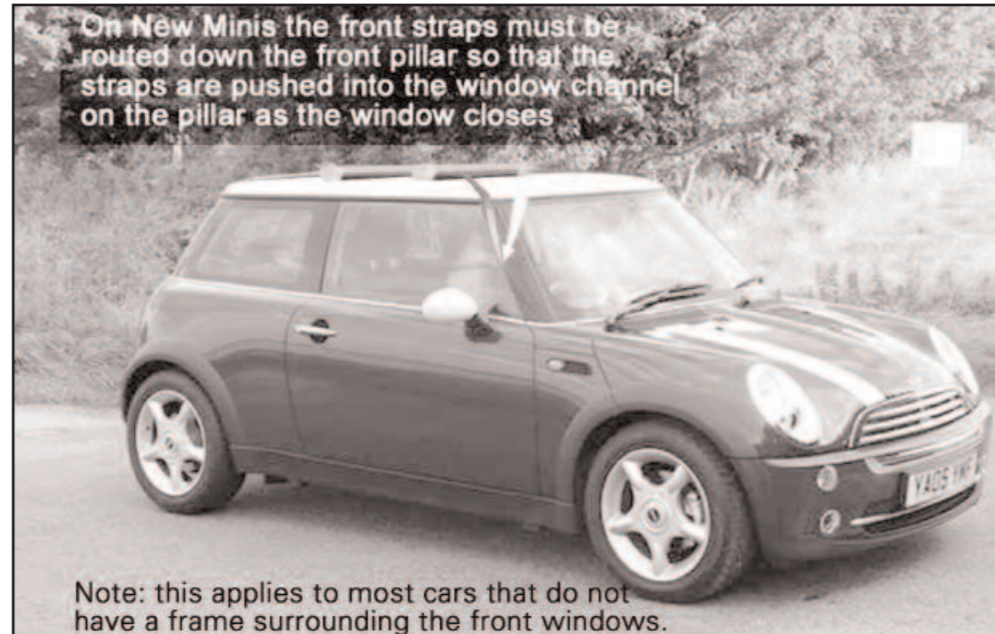

LONG LOADS

On cars with reasonably strong roofs loads up to 13ft have been successfully secured to X Rack.

Most long loads will require securing fore and aft. As shown right, additional non-elasticated straps or rope (NOT BUNGIES) must be secured at the front from the Hinge Bands (B) to the load on both sides. At the rear (A) to the rear loops as mentioned in Step 3 - LONG LOADS on page 1. Some long loads may require further securing fore and aft. Very long loads may require you driving more carefully and at lower speeds.



Caution these additional straps are only to prevent any load see-sawing and should not be overtightened as heavyhanded tightening could result in damage to your roof.



STRAP NOISE

Putting a single twist midway in all fixing straps will help keep strap vibration to a minimum and reduce any noise from your X Rack see right.

SIDE BARS/Roof rails

Route the front straps around the front or through the roof bars to suit your vehicle. You can use your existing bars for securing loads to as well as X Rack's existing fixing system.

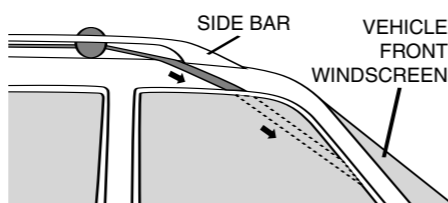

PACK CONTENTS X Rack 600 model.



'And finally thank you for choosing X Rack, please remember X Rack was designed to be a very convenient and inexpensive alternative to metal roof racks which as you know cost far more. It is not designed to replace metal racks which will take far larger or heavier loads, but if used within its limitations I am sure it will serve you very well. If you are happy with X Rack please tell your friends if not please tell me'

...Colin Roast MD Bigbobs Ltd

E&OE

PACK CONTENTS X Rack 800 model.



A MEMBER OF
ACID
ANTI-COPYING IN DESIGN

X Rack
600 & 800 models